

LEGEND:

- Proposed asphalt pavement
- Proposed unbound pavement
- Proposed unbound footway
- Proposed bound-permeable footway
- Proposed grass. See note 6.
- Proposed ducting. See note 13.
- Proposed 100mm service duct.
- Proposed timber edging E2-Type 1
- Proposed timber edging E2-Type 2
- Proposed timber fence TF
- Proposed sign on new post
- Proposed yellow road marking
- Proposed bike stand. Refer to Standard drawing 12994.
- Proposed cycle repair station. See note 10.
- Proposed feeder pillar.
- Proposed parking charge machine. See note 5.
- Proposed EV charging unit and protective bollards. See note 13.
- Relocated litter bin
- Relocated tourist information board
- Proposed pedestrian fence
- Existing stone wall

- NOTES**
1. All measures are in metres unless otherwise stated.
 2. Sign faces and elements of street furniture are not to scale.
 3. Manual dig excavations to be carried out in root protection areas.
 4. Due to the use of unbound surfacing wooden edging to be used for parking bay delineation. For details refer to drawings 100007748-4-BL-1100-01 and 100007748-4-0015.
 5. Contractor to liaise with the chosen supplier for phasing of the works to install the paying machine. Foundation of paying machine TBC by chosen supplier.
 6. Remove existing vegetation and 150mm topsoil from the indicated area. Excavation to be undertaken by hand or with air spade. Separate vegetation from the topsoil, and temporarily store the remaining topsoil on site. Return topsoil to the area just before seeding with the selected grass-seed mix, ensuring the topsoil is not overly compacted. The level of the new grass-seed must meet flush with the bordering levels.
 7. Contractor RAMS for works in close proximity to dry stone wall to be agreed prior to excavation commencing.
 8. All coordinates are based on an arbitrary grid rotated north as supplied by MHB Consultants. Survey undertaken in October 2021.
 9. Final arrangement of all relocated and proposed street furniture, including cycle racks, sleepers, rocks, etc. to be agreed on site with the car park officer.
 10. Cycle Repair Station comprised of bike repair stand and bike pump both in brushed finish Stainless Steel secured as per manufacturer's recommendations. Tool Tethers: 4mm stainless steel cable. Hand Tools: Phillips and flat head screwdrivers, 2.5, 3, 4, 5, 6, 8mm Allen keys, adjustable spanner star drive multi - tool, 8, 9, 10, 11mm multi spanners, 2 Tyre lever.
 11. Natsol Toilet, Double Zero-Discharge Type 2, Wooden Building (dimensions 1.9m x 2.46m x 2.24m). The two units to be in one double building, complete width of building to be 1.9m + 1.9m + 0.05m (gap) = 3.85m. Contractor shall liaise with toilet supplier and ensure the supply and installation of the toilets is integrated within the overall works programme.
 12. Contractor to liaise with Scottish Power for phasing of the works to install the new feeder pillar.
 13. Contractor to deal with EVCP supplier to determine specifications of the proposed ducting. Foundation of EV charging unit TBC by chosen supplier.
 14. Contractor to liaise with Scottish Power to confirm exact location of feeder pillar

Rev	Date	Description	Drn	Chk	App
4	APR 2023	ADDED EV CHARGING POINT	WL	NC	EM
3	JUL 2022	SHE BOX REVISED	ND	NC	VR
2	MAY 2022	AMENDMENT TO ANNOTATIONS AND NOTES - PEDESTRIAN FENCE ADDED	ND	NC	VR
1	APR 2022	FOR APPROVAL	ND	NC	DR
0	JAN 2022	FOR APPROVAL	HP	NC	DR

This drawing has been specifically prepared to meet the requirements of the named client and may contain design and innovative features which differ from conventional design standards.

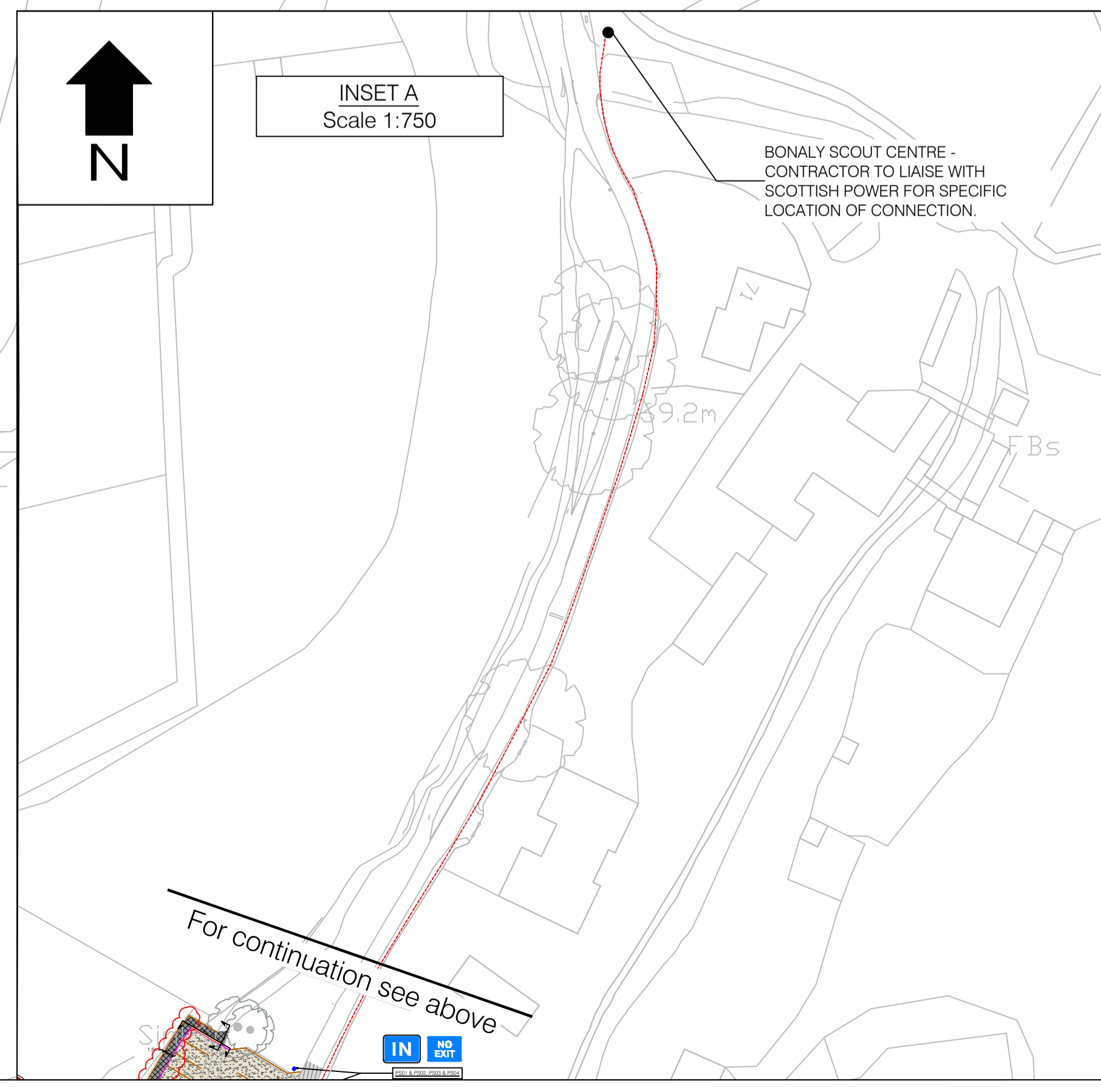

SAFETY, HEALTH AND ENVIRONMENTAL INFORMATION

In addition to the hazards/risks normally associated with the type of work detailed on this drawing, note the following significant risks and information identified by the designer

HAZARD
H001 POTENTIAL PRESENCE OF WILDLIFE - CONTRACTOR TO INSPECT AREAS OF NEW CONSTRUCTION FOR ANY RISKS TO WILDLIFE THROUGH EXCAVATION
H002 PRESENCE OF EV CHARGING UNITS - A 2-METRE RADIUS CLEARANCE OF CONDUCTING MATERIALS SURROUNDING THE EV CHARGING UNIT MAYBE REQUIRED, SUBJECT TO DETAILS OF EV UNIT POWER CONSUMPTION.

It is assumed that all works be carried out by a competent contractor working, where appropriate, to an approved method statement.

PROJECT CENTRE
www.marstonholdings.co.uk/projectcentre

Client
EDINBURGH
THE CITY OF EDINBURGH COUNCIL

Project
CITY OF EDINBURGH COUNCIL
PENTLAND HILLS REGIONAL PARK
CAR PARK DESIGN

Drawing Title
BONALY CAR PARK
GENERAL ARRANGEMENT

Drawing Status
FOR CONSTRUCTION

Drawn	Designed	Date	Scale	Size
HP	HP	JAN 2022	1:200	A1

Drawing No.
100007748-4-BL-0100

Rev
4